

Zusatzrüstungen
Supplementary Equipments

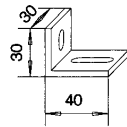

Universalwinkel Alu
Universal angle
aluminium
Art. 508

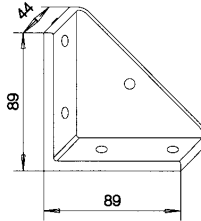

Justierwinkel groß; verdrehgesichert
Alu-Druckguß
Adjusting angle, large; nontwisting
die cast aluminium
Art. 340

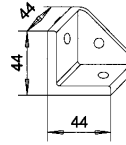

Justierwinkel klein; verdrehgesichert
Alu-Druckguß
Adjusting angle, small; nontwisting
die cast aluminium
Art. 292

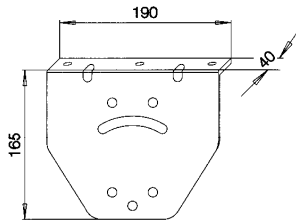

Stützknoten, verz.
für Profil 140AL
Connecting plate galv.,
for Section 140AL
Art. 1548

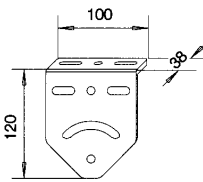

Stützknoten, verz.
für Profil 120AL
Connecting plate galv.,
for Section 120AL
Art. 257

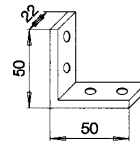

Universalwinkel
mittel verz.
Universal angle,
medium, galv.
Art. 286

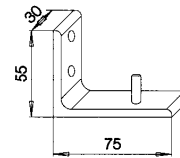

Schutzgitter-
winkel verz.
Angle for protective
lattice, galv.
Art. 2140

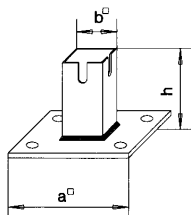

Säulenfuß, verz.
Column base, galv.,

Profil Section	454	606	909
Artikel Item	315	317	319
a	150	200	250
b	46	61	91
h	100	150	200

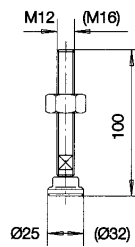

Spindelfuß, verz.
Spindle base, galv.
M 12 Art.314
M 16 Art.313

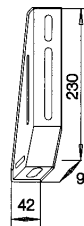

Fußanker, verz.
Base anchor galv.
Rechts Art.296
Links Art.297

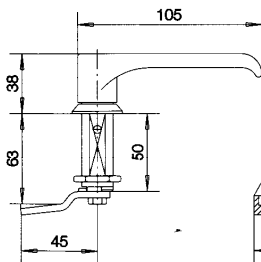

Klinkengriff mit
Sicherheitsschloß
Handle with
safety lock
Art. 1552

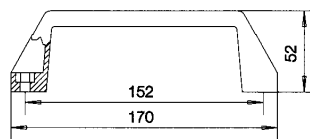

Handgriff, Kunststoff
Handle, plastic
Art. 1095 - 19

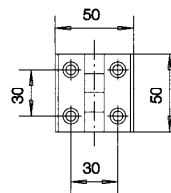

Scharnier, klein
Hinge, small
Art. 1056 - U 10

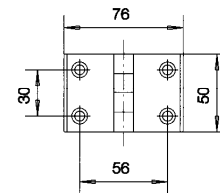

Scharnier, groß
Hinge, large
Art. 1056 - U 18

Zusatzrüstungen
Supplementary Equipments

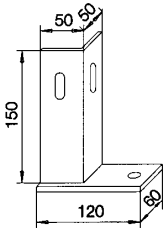

Stützfuß, klein verz.
Supporting leg, small, galv.
Art. 772 rechts right
Art. 773 links left

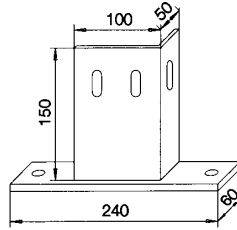

Stützfuß, groß verz.
Supporting leg, large, galv.
Art. 777 rechts right
Art. 778 links left

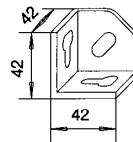

Universalwinkel, verz.
Universal angle, galv.
klein small
Art. 305

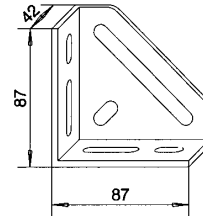

Universalwinkel, verz.
Universal angle, galv.
groß large
Art. 303

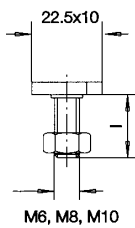

M6, M8, M10
Universalschraube
mit Sechskantmutter
verzinkt, nach
Werksnorm.
Universal screw
with hexagonal nut
galvanized, conforming
to work standard

Länge Length (mm)	Preisnummer/St. Price Number/Piece		
	M 6	M 8	M 10
	Artikel.	Artikel.	Artikel.
15	1005	1012	1025
20	1006	1013	1026
25	1007	1014	1027
30	1008	1015	1028
35		1016	1029
40	1009	1017	1030
50	1010	1018	1031
60	1011	1019	1032
70		1020	1033
80		1021	1034
100		1022	1035
125		1023	1036
150		1024	1037
175			1038
200			1039

Verschlusskappen, schwarzer Kunststoff, 5 mm dick
Sealing caps, black plastic, 5mm thick

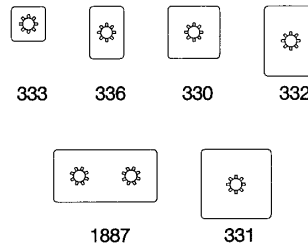

Profil Section	303	304	454	456	459	606	609	909
Artikel Item	333	336	330	332	1887	331	332	330
Anzahl Item	1	1	1	1	1	1	2	4

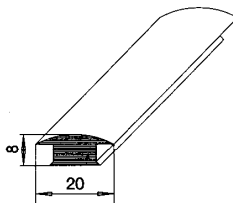

Nutleiste, Gummi weiß
lebensmittelfest
Grooved strip, white rubber
resistant to food
Art. 1276

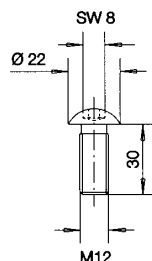

Befestigungsschrauben
Fixing screws
M 12, verz. galv.
Art. 1004

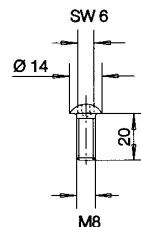

Befestigungsschrauben
Fixing screws
M 8, verz. galv.
Art. 1045

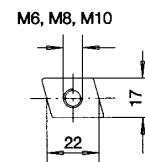

Gewindeplatte, verz.
Threaded plate, galv.
M 6 Art. 1040
M 8 Art. 1041
M 10 Art. 1042

Zusatz-ausrüstungen
Supplementary Equipments

Rohr verzinkt oder Kunststoff mit Stahlkern Galvanized tubing or plastic with steel core

Seitenführung 121 SFU
Lateral Guide 121 SFU

Alle Maße in mm
All dimensions in mm

Schleißleiste aus Kunststoff 30x20 fest mit dem Profil verschraubt Wearing strip of plastic material, 30x20, firmly bolted on section

Seitenführung 122 SFU
Lateral Guide 122 SFU

Alu-Winkel 30x30x4 verschraubt Verz. Stahlblech 100x30x3 verschraubt
Aluminium angle, 30x30x4, bolted Galvanized steel sheet, 100x30x3, bolted

Seitenführung 123 SFU Seitenführung 124 SFU
Lateral Guide 123 SFU Lateral Guide 124 SFU

Dichtleiste aus Kunststoff oder Gummi nach Absprache Sealing strip of plastic material or rubber, as specified

Seitenführung 126 SFU
Lateral Guide 126 SFU

Mit seitlichen Rollen D = 48 mm with lateral roller D = 48 mm
Abstand T = 50 oder 100 mm spacing T = 50 or 100 mm
Tragkraft pro Rolle 40 kp bearing capacity per roller = 40kp

Seitenführung 129 SFU
Lateral Guide 129 SFU

NB	200	300	400	500	650	800
Stahl verz.	steel, galvanized					
Aluminium	Aluminium					
Edelstahl	stainless steel					

Tropfwanne TW
Drip Pan TW