

WEGENER + STAPEL FÖRDERTECHNIK GMBH, Postfach 1298, D-29297 Bergen, Tel.: 05051 478-0,
Fax: 05051 478-10, E-Mail: vertrieb@westa.ws, Internet: www.westa.ws

Stand: 02/2010- Alle Maße in mm. Technische Änderungen vorbehalten. Fotos zeigen u.U. Teile, die in den
beschriebenen Komponenten nicht enthalten sind. State: 02/2010- All dimensions in mm. Subject to technical
modifications. Photos also show parts that are not included with the components described.

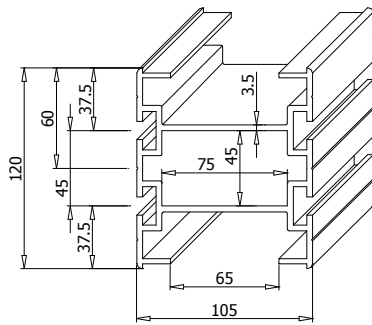

105 AL

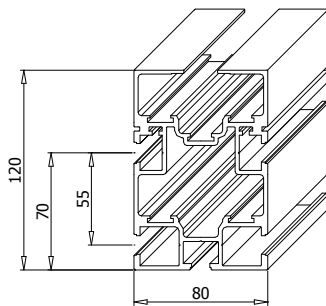

128 AL

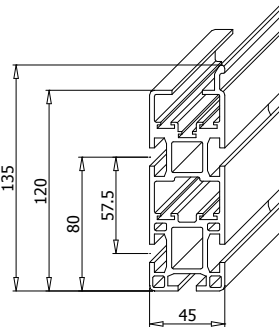

124 AL

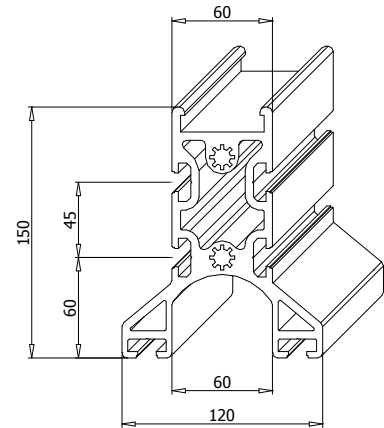

150 AL-K

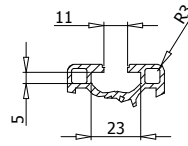

Nut
Groove

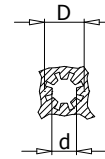

Kern
Core

| | Statische Werte | | Structural Data | |
|--------------------|-----------------|--------|-----------------|----------|
| | Profilnummer | | Section Number | |
| | 105 AL | 124 AL | 128 AL | 150 AL-K |
| $I_x \text{ cm}^4$ | 346,21 | 41,99 | 250,42 | 708,3 |
| $I_y \text{ cm}^4$ | 222,84 | 231,93 | 151,46 | 314,1 |
| $W_x \text{ cm}^3$ | 65,95 | 16,80 | 40,43 | 90,30 |
| $W_y \text{ cm}^3$ | 37,14 | 30,88 | 37,86 | 52,30 |
| F cm ² | 20,67 | 17,41 | 18,28 | 36,69 |
| G kg/m | 5,58 | 4,70 | 4,94 | 9,91 |